

DIRECTIONAL VALVES

EP08-35 Piloted Directional Element

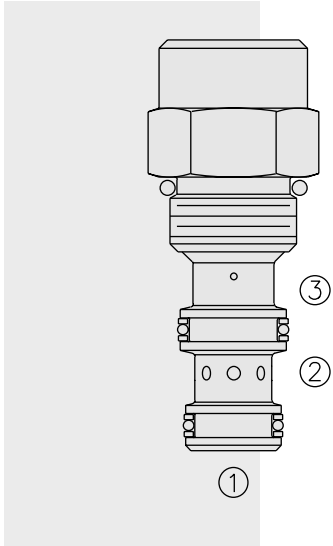

DESCRIPTION

A spool-type, screw-in, cartridge-style, hydraulic directional element, with multi-function potential when used with other directional, pressure, or flow control devices.

OPERATION

The EP08-35 is a spring-biased blocking valve which will shift to allow full flow from ① to ② only when pressure at ① exceeds the cumulative pressure of ③, plus the bias spring pressure value.

EP08-35 is a pilot-to-close directional valve.

With no pressure at ③, flow will be allowed from ① to ② once the bias spring force is overcome with pressure at ①.

FEATURES

- Multiple function/application potential.
- Low pressure drop.
- Industry common cavity
- Compact size.

RATINGS

Maximum Operating Pressure: 345 bar (5000 psi) with steel or ductile housing;
240 bar (3500 psi) with aluminum housing

Flow Rate: See Performance Chart

Maximum Internal Leakage: 115 ml per minute (7 cu. in. per minute)
at 345 bar (5000 psi)

Bias Springs:

- Code 10** 0.7 bar (10 psi)
- Code 40** 2.8 bar (40 psi)
- Code 80** 5.5 bar (80 psi)
- Code 110** 7.6 bar (110 psi)
- Code 150** 10.3 bar (150 psi)

Temperature: -40 to 120°C with standard Buna N seals

Filtration: See page 9.010.1

Fluids: Mineral-based or synthetics with lubricating properties at viscosities of 7.4 to 420 cSt (50 to 2000 ssu)

Installation: No restrictions; See page 9.020.1

Cavity: VC08-3; See page 9.108.1

Cavity Tool: CT08-3XX; See page 8.600.1

Seal Kit: SK08-3X-MM; See page 8.650.1

SYMBOLS

USASI/ISO:

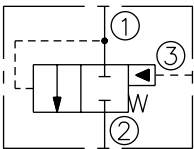

PERFORMANCE (Cartridge Only)

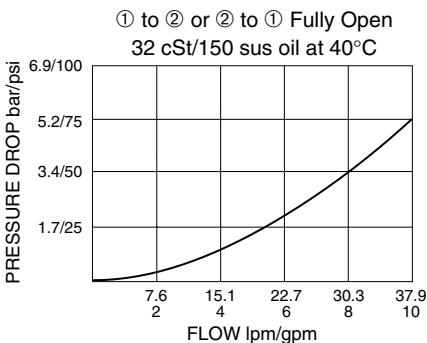

DIMENSIONS

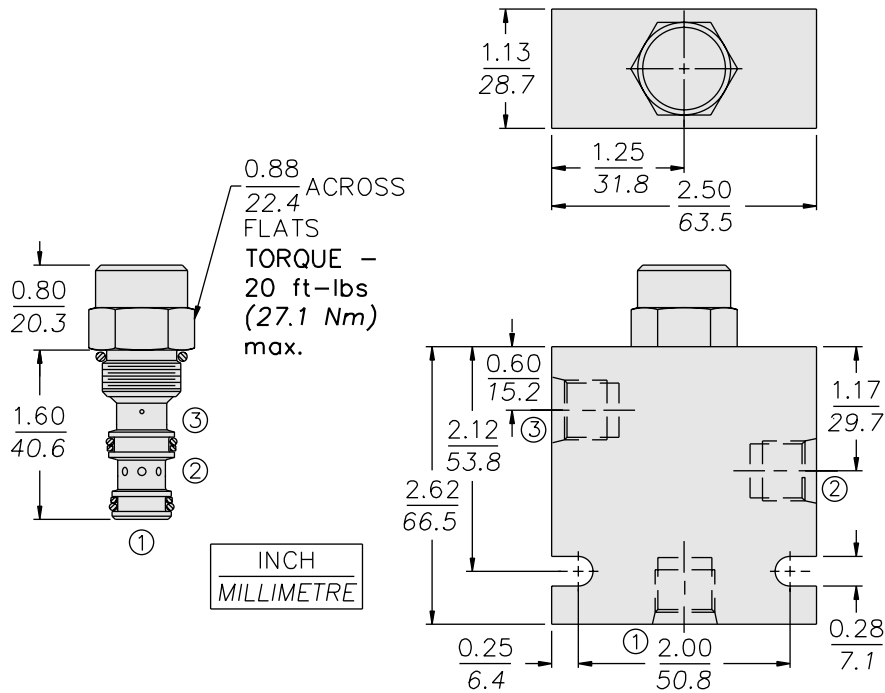

MATERIALS

Cartridge: Weight: 0.11 kg. (0.25 lbs.);
Steel with hardened work surfaces.
Zinc-plated exposed surfaces. Buna
N O-rings and back-ups standard.

Ported Body: Weight: 0.64 kg.
(1.4 lbs.), Steel, zinc-plated (code
"S"); or **Ductile Iron (code "D")**
standard, consult factory for weight,
dimensions may differ from
illustration; rated to 345 bar
(5000 psi); See page 8.008.1.

Ported Body: Weight: 0.36 kg.
(0.80 lbs.); Anodized high-strength
6061 T6 aluminum alloy, rated to
240 bar (3500 psi); See page
8.008.1.

TO ORDER

EP08-35 -

Porting

Cartridge Only **0**
SAE 6 (Ductile) **6TD**
SAE 6 (Steel) **6TS**
SAE 6 (Alum.) **6T**

Note: Aluminum body
rated for 240 bar
(3500 psi) max.

Bias Spring

10 0.7 bar (10 psi)
40 2.8 bar (40 psi)
80 5.5 bar (80 psi)
110 7.6 bar (110 psi)
150 10.3 bar (150 psi)

Seals

Buna N (Std.) **N**
Fluorocarbon **V**
Polyurethane **P**